

Standard Wall Cabinets

9 to 21 12

W0931	W0941
W1231	W1241
W1531	W1541
W1831	W1841
W2131	W2141

31, 41

24 to 42 12

W2431	W2441
W2731	W2741
W3031	W3041
W3331	W3341
W3631	W3641
W3931	W3941
W4231	W4241

31, 41

Wall Cabinets with Glass Doors (includes FIM)

15 & 18 12, 15

WG1531	WG1541
WG1831	WG1841

31, 41

12, 15 30 & 36

WG3031	WG3631
WG3041	WG3641

31, 41

For 15" depth, add "-15" to end of part #.
Ex: WG3041-15.

Wall Blind Cabinets

24 to 33 12

WB2431_	WB2441_
WB2731_	WB2741_
WB3031_	WB3041_
WB3331_	WB3341_

31, 41 (shown right)

36 to 42 12

31, 41 (shown right)

Specify blind left or right (L/R).
Ex: WB3031L

WB3631_	WB3641_
WB3931_	WB3941_
WB4231_	WB4241_

	Face	Pull To	Exposed Stile	Wall Gap
WB24	12	25 to 29	1 to 5	1 to 5
WB27	15	28 to 32	1 to 5	1 to 5
WB30	18	31 to 35	1 to 5	1 to 5
WB33	21	34 to 38	1 to 5	1 to 5
WB36	24P	37 to 41	1 to 5	1 to 5
WB39	27P	40 to 44	1 to 5	1 to 5
WB42	30P	43 to 47	1 to 5	1 to 5

Wall Diagonal Cabinets

24, 27 24, 27

*27 is 15" deep.

31, 41

12, 15 (shown as WDC)

WD_2431	WD_2441
WD_2731	WD_2741

Fill in blank with "C" (adjustable shelf, solid door) or "L" (lazy-susan, solid door). Example: WDC2441

Wall Diagonal w/ Glass Door (includes FIM)

24, 27* 24, 27*

*27 is 15" deep.

31, 41

12, 15

WDG2431	WDG2441
WDG2731	WDG2741

Wall Open-shelf Cabinets

24 & 30 12, 15*

31, 41

WO2431	WO2441
WO3031	WO3041

*For 15" depth, add "-15" to end of part #.
Ex: WO3041-15.

Wall Open End

6 12

31, 41

Part #	# of Shelves
WOE31_	3
WOE41_	4

(shown left)

Specify left or right (L/R). Ex: WOE41R

Wall Angle end

12 12

31, 41

WA1231	WA1241
--------	--------

Wall Microwave Cabinets

30 21

33, 43

Opening height = 14-7/8";
Opening width = 25"

WM3033
WM3043

30 12

33, 43

Opening height = 17";
Opening width = 27"

WMS3033
WMS3043

Wall Cabinet for Over Sink / Peninsula

8' Ceiling: 28" = utilized like 30"
7' Ceiling: 18"

30 & 36 12

28

W3028
W3628

DID

30 & 36 12

18

W3018
W3618

DID

For 18" H & 28" H cabinets, add "P" after "W" for Wall Peninsula cabinet.
Example: WP3028

Wall Cabinet for Over Range

8' Ceiling: 25" = utilized like 27"
7' Ceiling: 15"

30 & 36 12

25

W3025
W3625

30 & 36 12

15

W3015
W3615

DID

Wall Cabinet for Over Fridge / Over Range

8' Ceiling: 22" = utilized like 24"
7' Ceiling: 12"

30 to 39 12

12, 22

W3012	W3022
W3312	W3322
W3612	W3622
W3912	W3922

DID

Wall Refrigerator Cabinet

30 to 39 24

12, 22

WR3012	WR3022
WR3312	WR3322
WR3612	WR3622
WR3912	WR3922

DID

Wall Peninsula Cabinets

8' Ceiling: 25" = utilized like 27"
7' Ceiling: 15"

15 & 18 12

25

WP1525
WP1825

30 & 36 12

25

WP3025
WP3625

15 & 18 12

15

WP1515
WP1815

DID

30 & 36 12

15

WP3015
WP3615

DID

Wall Blind Peninsula

24 & 27 12

31, 41

Specify blind left or right (L/R).
Ex: WBP2441L

(shown blind right)

Refer to std Wall Blind for table with blind side info

WBP2431_	WBP2441_
WBP2731_	WBP2741_

Wall Blind Peninsula

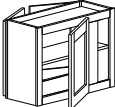

30 12
15, 25

Specify blind left or right (L/R).
Ex: WBP3015L

(shown blind right)

DID **WBP3015_**
WBP3025_

15" height does not have shelf

Refer to std Wall Blind for table with blind side info

Base/Vanity/Peninsula Cabinets

All Base Peninsula (BP...) cabs have functioning doors & toe space on back.

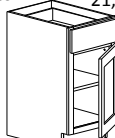

12 to 21 21, 24
34-1/2

B12	V12	BP12
B15	V15	BP15
B18	V18	BP18
B21	V21	BP21

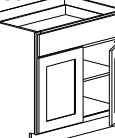

24 to 36 21, 24
34-1/2

B24	V24	BP24
B27	V27	BP27
B30	V30	BP30
B33	V33	BP33
B36	V36	BP36

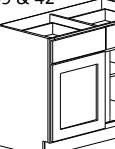

39 & 42 21, 24
34-1/2

DID **B39** **V39** **BP39**
B42 **V42** **BP42**



9 to 21 21, 24
34-1/2

BFH09	VFH09	BPFH09
BFH12	VFH12	BPFH12
BFH15	VFH15	BPFH15
BFH18	VFH18	BPFH18
BFH21	VFH21	BPFH21

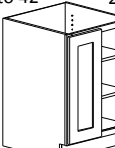

24 to 42 21, 24
34-1/2

BFH24	VFH24	BPFH24
BFH27	VFH27	BPFH27
BFH30	VFH30	BPFH30
BFH33	VFH33	BPFH33
BFH36	VFH36	BPFH36
BFH39	VFH39	BPFH39
BFH42	VFH42	BPFH42

Base/Vanity Sink

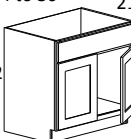

24 to 36 21, 24
34-1/2

BSC24	VS24
BSC27	VS27
BSC30	VS30
BSC33	VS33
BSC36	VS36

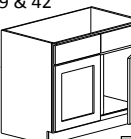

39 & 42 21, 24
34-1/2

BSC39	VS39	DID
BSC42	VS42	

Base Sink cabinets can also be used for cooktops.

Base Sink Diagonal Fronts



36 & 39 34-1/2

BSDF36
BSDF39

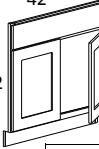

42 34-1/2

BSDF42

	Sink Bowl Type	Face Size (of Base) Used	Wall Corner w/ 24"D cabs
B SDF36	Wet bar	15	36 x 36
B SDF39	Single	18	39 x 39
B SDF42	Double	24P	42 x 42

Base Sink Diagonal Floor 42" x 42" not shown. **B**SDFLR42

Base/Vanity Drawer Stacks



12 to 36 21, 24
34-1/2

BD3-12	VD3-12
BD3-15	VD3-15
BD3-18	VD3-18
BD3-21	VD3-21
BD3-24	VD3-24
DID BD3-27	VD3-27
BD3-30	VD3-30
BD3-33	VD3-33
BD3-36	VD3-36

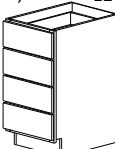

21, 24 12 to 36
34-1/2

BD4-12	VD4-12
BD4-15	VD4-15
BD4-18	VD4-18
BD4-21	VD4-21
BD4-24	VD4-24
BD4-27	VD4-27
BD4-30	VD4-30
BD4-33	VD4-33
BD4-36	VD4-36

Base Cooktop w/ Drawers

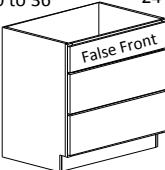

30 to 36 24
34-1/2

False Front

BCD30
BCD33
BCD36

(To reduce 2 lower drawer boxes to 15" deep, use Cook N' Vent modification—MOD-CNV)

Base Blind Cabinets

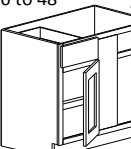

36 to 48 24
34-1/2

(shown blind right)

Specify blind left or right (L/R).
Example: BB39L

	Face	Pull To	Exposed Stile	Wall Gap
BB36	12	38 to 43	2 to 7	2 to 7
BB39	15	41 to 46	2 to 7	2 to 7
BB42	18	44 to 49	2 to 7	2 to 7
BB45	21	47 to 52	2 to 7	2 to 7
BB48	24P	50 to 55	2 to 7	2 to 7

Base Blind Peninsula

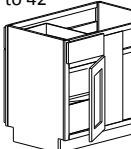

36 to 42 24
34-1/2

(shown blind right)

BBP36_ **DID**
BBP39_
BBP42_

Refer to std Base Blind for table with blind side info

Specify blind left or right (L/R).
Example: BBP36L

Base Easy-Reach & Base Lazy-Susan

Note: Frameless Construction

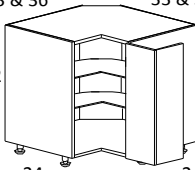

33 & 36 33 & 36
34-1/2

24 (shown as BER) 24

B_33 **DID**
B_36

Fill in blank with "ER" for easy-reach shelves or "LS" for lazy-susan.
Example: BLS33

Base Diagonal Corner & Base Diagonal w/ Lazy-susan

Note: Frameless Construction

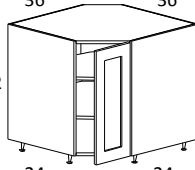

36 36
34-1/2

24 24

BD_36

Fill in blank with "C" for shelves or "L" for lazy-susan. Example: BDL36

Base/Vanity Garbage Can Holders

Note: Frameless Construction

Single

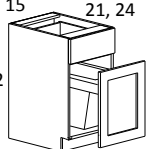

15 21, 24
34-1/2

BSGCH15
VSGCH15

Double

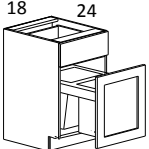

18 24
34-1/2

BDGCH18

Base Open-shelf



24 & 30 12, 15
34-1/2

BO2412 **B**O2415
BO3012 **B**O3015

Base "open-shelf" with Full-Height Glass doors (includes FIM)

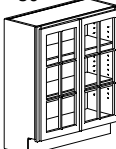

30 12, 15
34-1/2

BFHG3012 **B**FHG3015

Base Angle Cabinets

Base Angle end

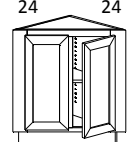

24 24
34-1/2

BA24

Can be used as left or right

Base Twin Angle end

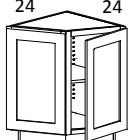

24 24
34-1/2

BAC24

Can be used as left or right

Base Angle Cabinet

Base Angle Transition

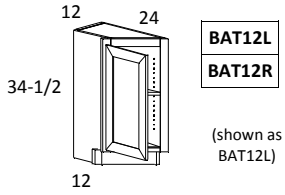

(shown as BAT12L)

L or R at the end of the part # denotes if it is for left or right end of run.

Vanity Combos (For Single Bowl)

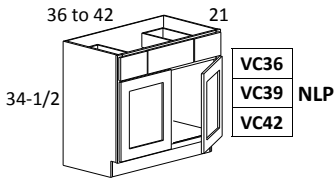

(36 = 18 center + 9 drawers & 18 doors)
(39 = 21 center + 9 drawers & 19-1/2 doors)
(42 = 18 center + 12 drawers & 21 doors)

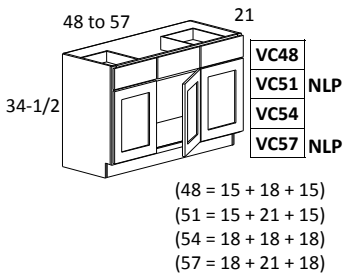

(48 = 15 + 18 + 15)
(51 = 15 + 21 + 15)
(54 = 18 + 18 + 18)
(57 = 18 + 21 + 18)

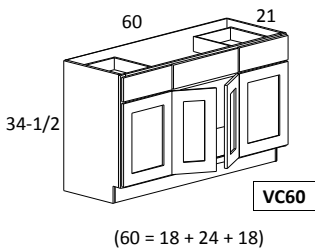

(60 = 18 + 24 + 18)

Vanity Combos with Drawer Stacks (For Single Bowl)

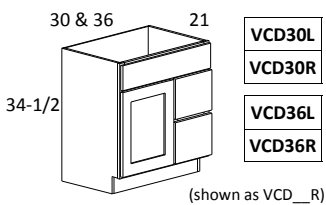

(shown as VCD_ _R)

(30 = 18 door + 12 drawers)
(36 = 21 door + 15 drawers)

L or R at the end of the part # denotes if drawer stack is on left or right.

Vanity Combos with Drawer Stacks (For Single Bowl)

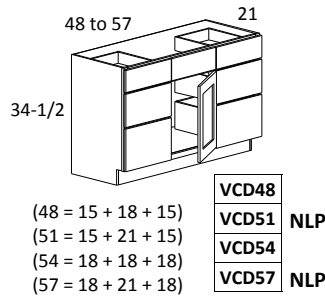

(48 = 15 + 18 + 15)
(51 = 15 + 21 + 15)
(54 = 18 + 18 + 18)
(57 = 18 + 21 + 18)

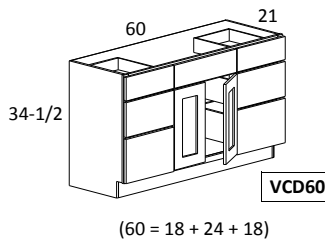

(60 = 18 + 24 + 18)

Vanity Combos with Drawer Stack (For Double Bowl)

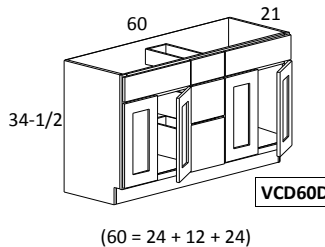

(60 = 24 + 12 + 24)

Vanity Hamper Cabinet

Note: Frameless Construction

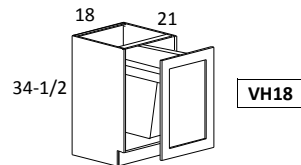

Johnny Wall

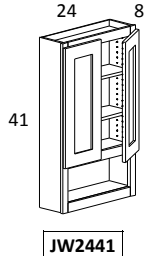

JW2441

Recessed Medicine Cabinet

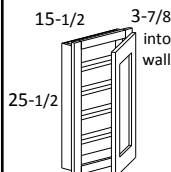

MED1626

Desk Cabinets with Full-Height Doors

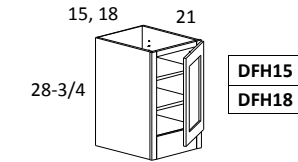

DFH15
DFH18

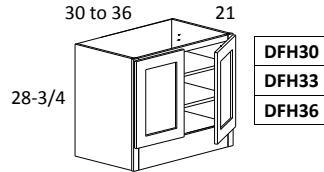

DFH30
DFH33
DFH36

Desk File Drawer Insert

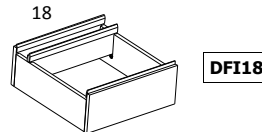

DFI18

Fits behind DFH18 door.
Insert is bottomless.

Pencil Drawer

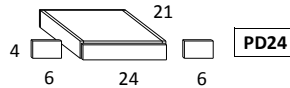

PD24

(6" fillers allow for expansion to 36")

Tall Pantry Cabinets

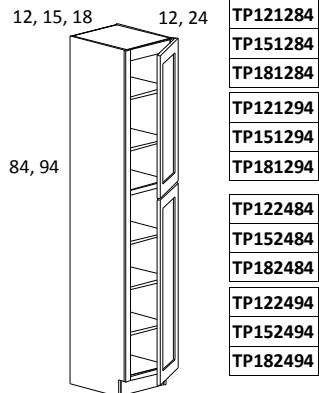

TP121284
TP151284
TP181284
TP121294
TP151294
TP181294
TP122484
TP152484
TP182484
TP122494
TP152494
TP182494

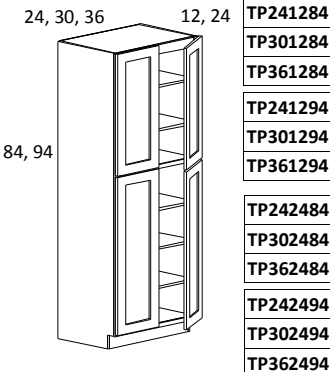

TP241284
TP301284
TP361284
TP241294
TP301294
TP361294
TP242484
TP302484
TP362484
TP242494
TP302494
TP362494

Tall Single Oven Cabinets

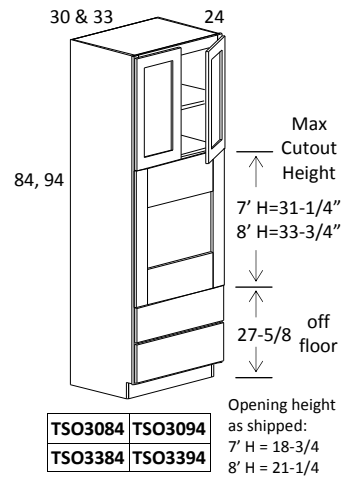

Max Cutout Height

7' H = 31-1/4"
8' H = 33-3/4"

27-5/8 off floor

Opening height as shipped:
7' H = 18-3/4"
8' H = 21-1/4"

TSO3084 TSO3094
TSO3384 TSO3394

Tall Double Oven Cabinets

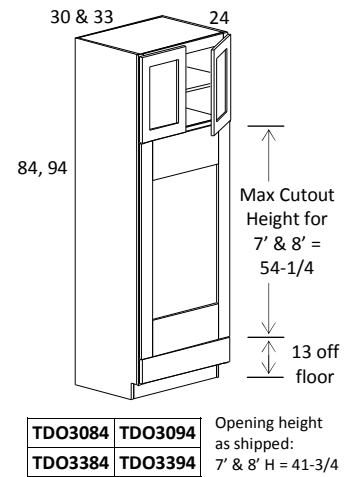

Max Cutout Height for 7' & 8' = 54-1/4"

13 off floor

Opening height as shipped:
7' & 8' H = 41-3/4"

TDO3084 TDO3094
TDO3384 TDO3394

Tall Triple Oven Cabinets

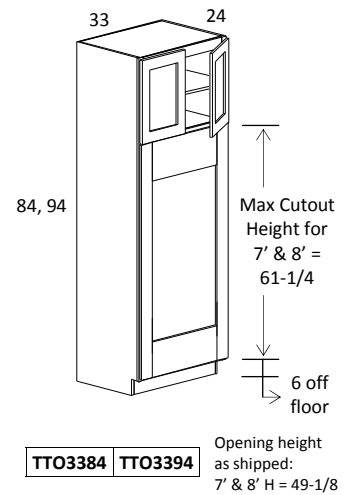

Max Cutout Height for 7' & 8' = 61-1/4"

6 off floor

Opening height as shipped:
7' & 8' H = 49-1/8"

TTO3384 TTO3394

For ALL Talls, don't forget about Detached Toe Modification—MOD-DT, if you have a lower ceiling height.

Spice Pull-Outs

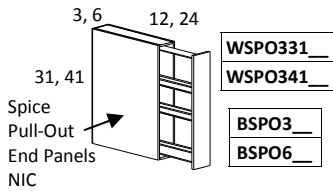

For BSPOs, installer must fabricate toe space on site.

All spice pull-outs must end in desired face nomenclature. Plain is "-PL"; all other face options are shown below with their respective nomenclature ("-").

Spice Pull-Out End Panels

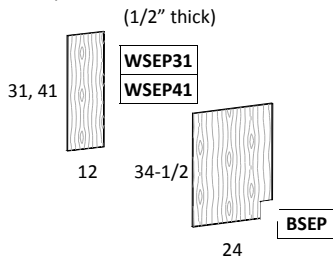

3" Spice Pull-out Faces

These items are for the 3" Spice Pull-Outs. Item height will be made to fit height of spice pull-out requested. Use this nomenclature at end of spice pull-out part #: Ex: WSP0331-FL

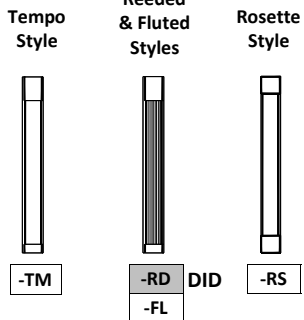

6" Base Spice Pull-out Face

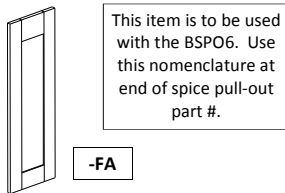

Tray Divider Insert 15"

(designed to fit in standard base, qty of 2 in deep wall refrigerator, or wall oven [top section]) **TDI15**

Tray Base Insert

(for full-height base) (5/8" thick; can use more than 1 per cabinet, equally spaced) **TBI-FHD**

Cabinet Accessories

Wall Wine Racks

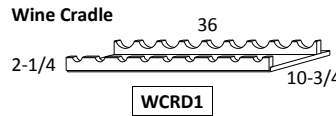
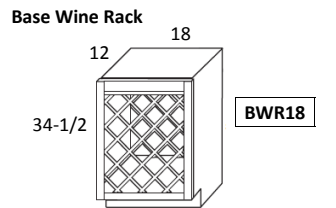
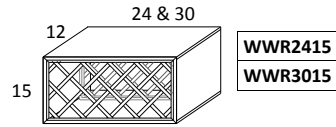
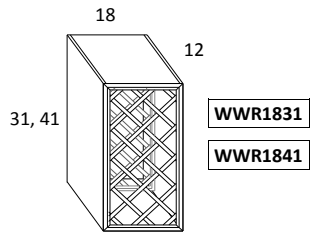

Item Part #	# of 3-1/2" Wine Bottle Holes in Item
WWR1831	23
WWR1841	30
WWR2415	11
WWR3015	14
BWR18	23
WCRD1	9

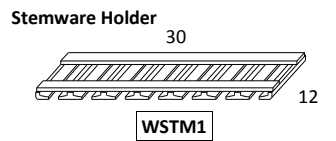

Wall Organizers

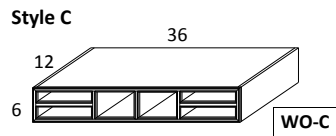
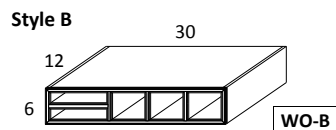
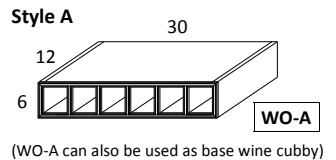

Cabinet Accessories

Roll-Out Shelf Kits

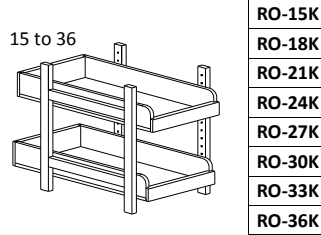

For vanity depth, add "V" to end of part #. Example: RO-18KV

Extra Adjustable Shelves

Half-Depth Shelf (10-1/2"D) **AS_W**

3/4-Depth Shelf (15-1/2"D) **AS_B**

Full-Depth Shelf (23-1/2"D) **AS_T**

For all adjustable shelves, fill in blank with size in 3" increments, according to cabinet width; 09-42. Ex: AS09W



Tip-Out Trays



Fillers

Plain

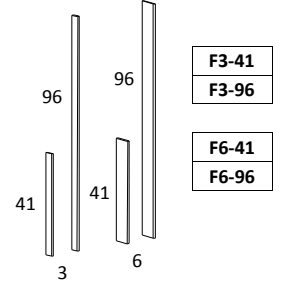

Tempo (TM)

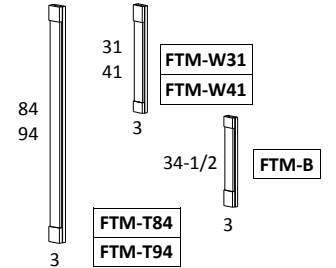

Reeded (RD) & Fluted (FL)

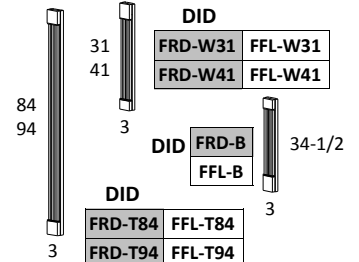

Angled Fillers

Tempo (TM)

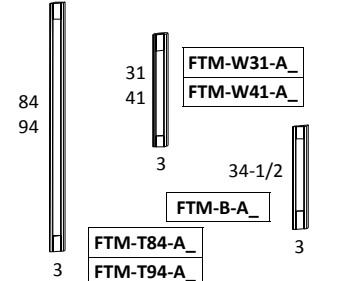

Reeded (RD) & Fluted (FL)

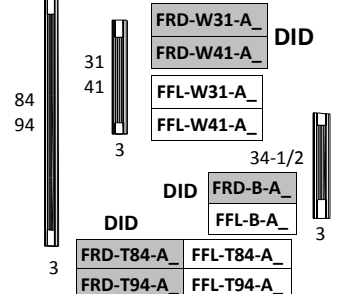

For angled fillers, specify left or right (L / R). Example: FFL-W41-AR

End Panels

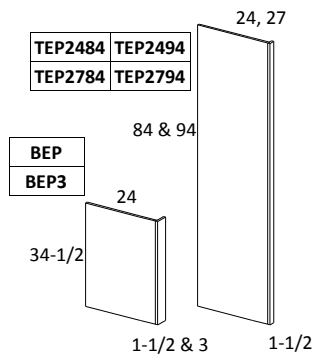

Styled Ends

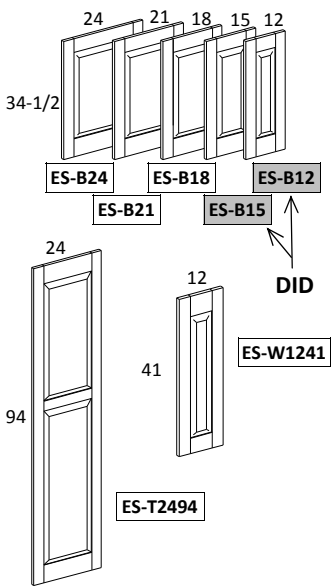

Skins—1/4" Plywood & Beadboard (-BD)

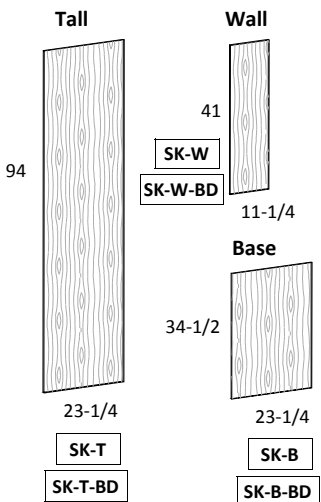

Toeskin (1/4")

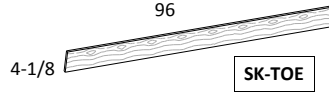

Sheet Goods

1/4" thick Plywood

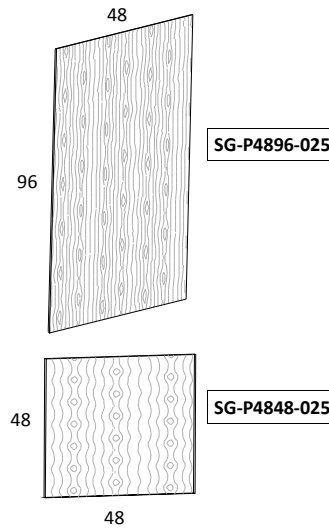

Mouldings

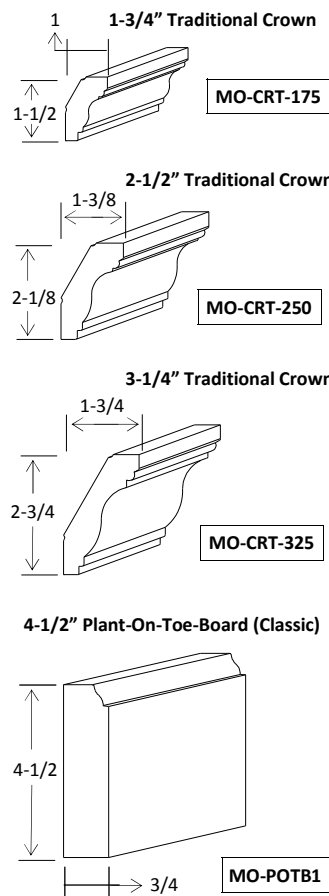

Mouldings

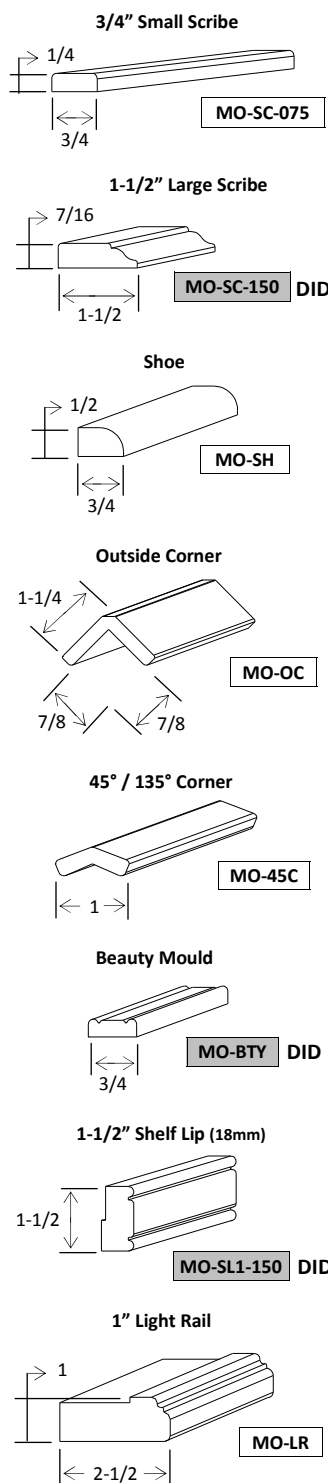

Decorative Valances

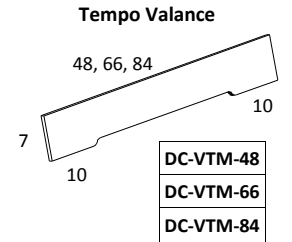

Double Lipped Shelf

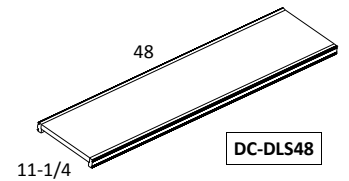

Knee-Wall End Cap

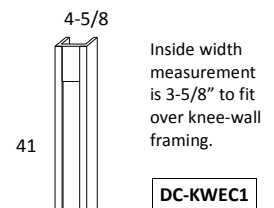

Glass Doors

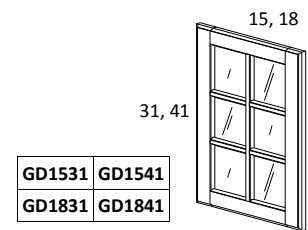

Decorative Onlay



Decorative Hoods

Basic Façade Hood— 30"W x 28"H
(8' application; 4" exposed top rail)



66" off floor

HD-BF3028

Classic Wood Hood

(8' & 9' Applications)

36, 42, & 48



28
38

66" off floor

HD-CW3628	HD-CW3638
HD-CW4228	HD-CW4238
HD-CW4828	HD-CW4838

Arched Raised Panel Wood Hood

(8' & 9' Applications)

36, 42, & 48



28
38

(Corbels are optional; see corbel section.)

HD-AR3628	HD-AR3638
HD-AR4228	HD-AR4238
HD-AR4828	HD-AR4838

Chef Arched Wood Hood

(8' & 9' Applications)

36, 42, & 48



42

HD-CA3642
HD-CA4242
HD-CA4842

Wood Hoods (All Styles except BF)

Stove Width	Hood Min. Width
30	36
36	42
42	48

Decorative Hoods

Chef Stainless Steel Hood

36

33 to 46-7/8
(Trimnable)



(Blower included)

HD-CS36TR

Liners for Wood Hoods

Part #	Hood Style Used With	Hood Width
HD-LNR-9092	BF	30
HD-LNR-9136	CW, AR, & CA	36
HD-LNR-9137	CW, AR, & CA	42
HD-LNR-9138	CW, AR, & CA	48

Blowers for Wood Hoods

350 CFM



HD-FAN-02A350

670 CFM



HD-FAN-06W670

Blower Part # Ending In	Used With Liner Part # Ending In
02A350	9092, 9136, 9137, & 9138
06W670	9136, 9137, & 9138

Corbels

Basic Corbel #1

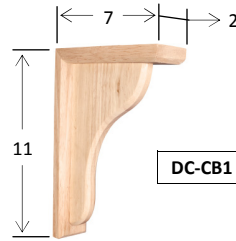

DC-CB1

Carved Corbel—Large

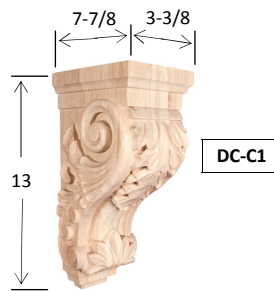

DC-C1

Hardware

Epoxy-coated Under-mount Drawer Slides

NP

HW-SEU21
HW-SEU24

Full-Extension (Accuride type) Drawer Slides—Soft-close



HW-SFXA20S (20 = 21" vanity)
HW-SFXA22S (22 = 24" base)

Wire Door Stop



HW-AWDS

Base Blind Lazy-Susan (6842-__)



(31 fits in BB42)
(33 fits in BB45)

HW-BBLS-6842-31
HW-BBLS-6842-33

Hardware

110° Hinge

(Single Door [-S] or Paired Doors [-P])



HW-H110-S
HW-H110-P

165° Lazy-Susan Stile Hinge



HW-H165LSS

Lazy-Susan Center Hinge



HW-HLSC

Shelf Supports



HW-MSS

(12 per pack)

Door Bumpers

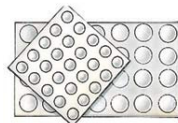

HW-MDB

(100 per sheet)

Miscellaneous

Color Sample Block

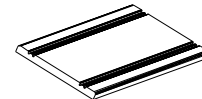

MO-CSMPL-6

Drawer Front (Face) Sample

ND

FA-SMPL

Touch-Up Kit



TUK

STANDARD INFORMATION

Standard Cabinet Features:

- Light **glazing** for all colors
- All **plywood & solid wood** construction
 - **1/2" thick** cabinet sides, tops, & bottoms
 - Interiors are **UV coated birch** veneer plywood
 - Adjustable shelves are **3/4" thick UV birch** plywood
 - Drawer boxes are **5/8" doweled UV birch** plywood
 - Drawer Fronts are **5-piece raised panel**
- Cabinet heights, in conjunction with walls and walls, are designed to allow for attractive crown moulding applications
- Wall cabinets have **2-1/4" top & bottom rails** which allow for under cabinet lighting without light rail moulding, and 2" flat at top allows for moulding.

Allowable Cabinet Modifications:

Increase Depth (ID)
(in 3" increments up to 30" deep)

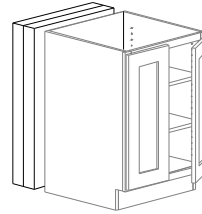

MOD-ID

Reduce Depth (RD)
(in 3" increments down to 6" deep)

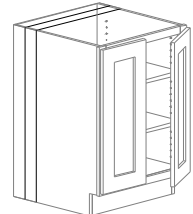

MOD-RD

(Drawer Box depth does not change.)

Detached Toe (DT)

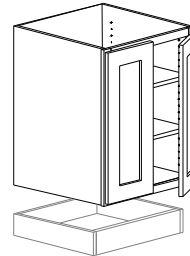

MOD-DT

Frame & Door Only (FDO)

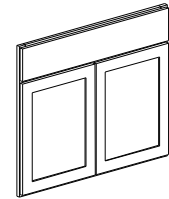

MOD-FDO

Available Colors:

- STANDARD COLORS:
 - Glazed **Honey Maple** (GHM)
 - Glazed **Spice Maple** (GSM)
 - Glazed **Medium Maple** (GMM)
 - Glazed **Walnut Alder** (GWA)
 - Glazed **Black-Cherry Alder** (GBC)
- CUSTOM COLORS AVAILABLE ON MAPLE OR ALDER:
 - Custom **Stained Maple** (CSM)
 - Custom **Glazed Maple** (CGM)
 - Custom **Stained Alder** (CSA)
 - Custom **Glazed Alder** (CGA)

Prep For Glass (PFG)

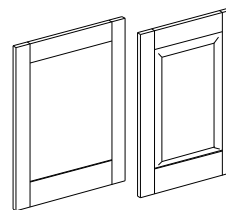

MOD-PFG

Finished Interior Matching (FIM)

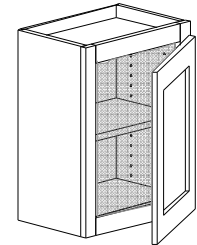

MOD-FIM

(Finished Interior is a separate option, add MOD-FIM if finished interior is desired.)

Door & Drawer Front Detail:

Classic Raised Panel Door & Drawer Front

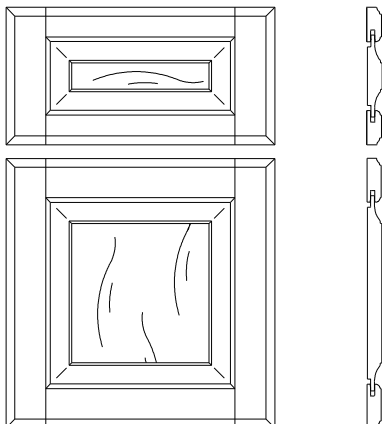

For Office Use Only:

- Abbreviation Meanings:
 - ELT = Extended Lead Time
 - NLP = Non-Linear Price (items requiring additional labor & materials; example: vanity combo 51" [VC51])
 - DID = Discontinued with Inventory Depletion

TECHNICAL INFORMATION

7' Ceiling—Elevation

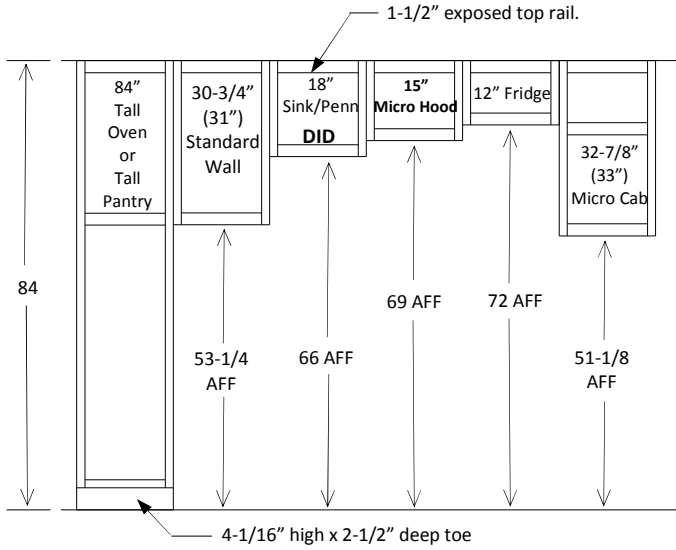

AFF = Above Finished Floor

8' Ceiling—Elevation

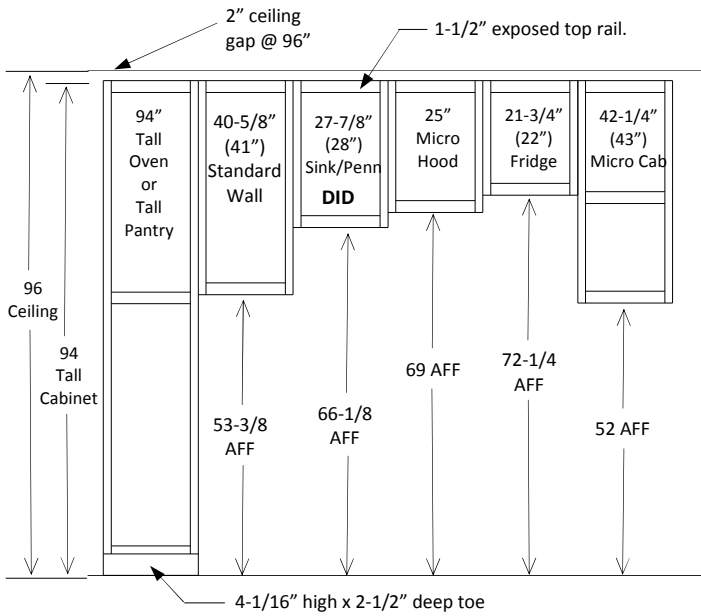

AFF = Above Finished Floor